

**TRACTORS - TRUCKS - LIVESTOCK EQUIPMENT -
HAY EQUIPMENT - COMBINES - PLANTERS - HOUSEHOLD -
MUCH MORE!**

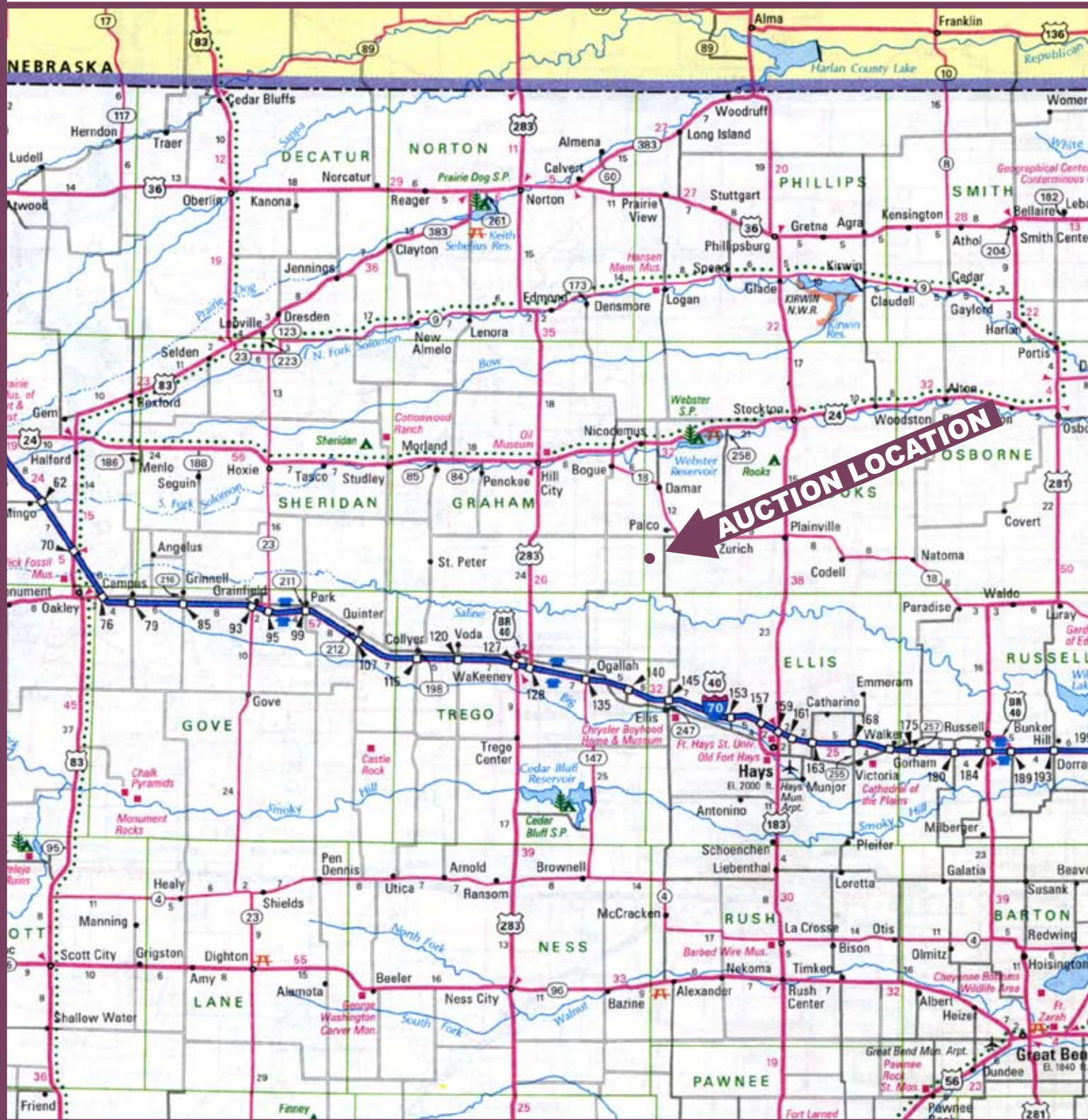

Auction Note:

Everett passed away in November of 2009 and was particular about his machinery. It has been shedded when not in use and maintained very well. Some of the machinery was purchased in 2009, a few months before his passing.



AUCTION & REALTY CO., INC.
2707 Broadway Office Phone (785) 628-2851
HAYS, KANSAS 67601

SPECIALISTS IN FARM & RANCH SALES . . .
WITH COMPLETE AUCTION SERVICE

COMBINE • TRACTORS • FIELD EQUIPMENT • HOUSEHOLD



AUCTION



SELLER: Everett McKenna Estate

MONDAY, APRIL 5, 2010

• TIME: 9:00 A.M

**• COMBINE, TRACTORS & FARM EQUIPMENT TO SELL at 1:00 P.M.
TRUCKS & TRAILERS TO FOLLOW**

**• AUCTION LOCATION: • From the southwest corner of Palco, Kansas, on the blacktop,
3 miles south to Z Road, 1 mile west to 2 Road, 1/4 mile south. Signs will be posted.**



Farmland Auction & Realty Co., Inc.

2707 Broadway, Hays, Kansas 67601

(785) 628-2851 Toll Free 1-888-671-2851

E-Mail: farmland@farmlandauction.com Web: www.farmlandauction.com





AUCTION



MONDAY, APRIL 5, 2010

•TIME: 9:30 A.M

•TRACTORS, COMBINES, & FARM EQUIPMENT TO SELL at 1:00 P.M.

•TRUCKS & TRAILERS TO FOLLOW

•AUCTION LOCATION: •From the Southwest corner of Palco , Kansas, on the black-top, 3 miles South to Z Road , 1 mile West to 2 Road, ¼ mile South. Signs will be posted.



TRUCKS & PICKUPS

- 2000 Ford F-350 w/2002 hydra bed, 4x4, 6.3 diesel engine, 5 speed, high mileage
- 1984 Ford F-350 4x4 flatbed, diesel, 6.2, 4 speed
- 1983 Ford F-250 Diesel, 4 speed, spray truck w/ Simpson 60' boom sprayer, 300 gal tank, foam marker, Raven control
- 1989 Freightliner 855 Cummings engine, 400 hp. 285/75R 24.5 tires, 13 speed, Hi & low Eaton Fuller Road Range
- 1989 Freightliner w/3406 Cat engine, sleeper, 425 hp. Aluminum wheels, 285/75R 24.5 tires, AC, Air ride suspension & seat
- 1981 IHC 4300 Transtar 9 speed, Hi & low w/over-drive, 855 Cummings engine, 300 hp. 11R-24.5 tires, twin screw
- 1979 IHC 4300 Twin screw, 52" sides, diesel, 20' steel box & hoist, 9 speed
- 1978 GMC 6500 Sierra, 427 eng. 5 & 2 speed, 18' Knapheide steel box w/hoist, 40' sides w/12" tip tops

FIELD EQUIPMENT

- J.D. 1820 42' No-till drill, carbide tip points, recapped press wheels, new bushings, Ser. # H01820X675331 W/J.D. 1900 dual tank cart, single shoot, Ser. # H01900T675193
- Case IH DMI 5300 45' fertilizer applicator w/Degelman harrows, Raven 440 cold flow w/monitor 20" spacing Ser.# JFH0005345
- J.D. 630 30' Tandem disc w/harrows, 9" spacing, self leveling, transport wheels
- SF 28' Tandem disc, 7 1/2 spacing, Ser. # 1495-128, model 1433-28
- SF 7-5 Undercutter w/pressure down treads, Ser. # 03672K20000017, model 3672-35
- SF 3060 Follow King w/SF treads, Ser. # 3097-025, model 3060-42
- SF 3060 Follow King w/SF harrows, Ser. # 3060-G08002, model 3060-42
- Orthman 11 Shank ripper
- Landoll 1632 16' pull type grader (near new)
- Holcomb model 1200 scraper
- 8' Rock picker (near new)
- 8' Scraper

LIVESTOCK & GRAIN TRAILERS

- 2008 Titan Livestock trailer 6'8" x 235/80 R16 tires, ID# 4TGG2420X8104999
- 2000 Titan livestock trailer "x 24' 235/85 R16 tires, ID# 4T6624205Y1015856
- 1980 Merritt 20' pup Grain trailer, model GSS-229-11, 11R-24.5 tires, ID# 1MT2P2316AH002900
- 1979 Doonan 40' Grain trailer, new rollover tarp, 11R-24.5 tires, ID#0579420207
- 1975 Cornhusker 38' Grain trailer, 11R-24.5 tires, ID#80062674473
- 1956 Bilt flat bed, hay hauler, extended 40+ ft. ID #T331093
- EZ Trail, model 700 Grain Cart
- 6 x 16 tandem axle flat bed trailer
- 6 x 10' 2 wheel tilt trailer
- E-Z trail 672 header trailer

SHOP EQUIPMENT

- Large Speedaire shop compressor
- Weldanpower 225 portable welder/generator
- Millermatic 252 wire welder
- Thermal Dynamic Cutmaster 101 plasma cutter
- Coats 2020 Pneumatic Tire changer
- Puma portable air compressor (gas)
- Acetylene gauges & hoses
- Electric air compressor
- Large shop press
- 2-bench grinders
- 20 ton floor jack
- 20 ton bottle jack
- Dayco coupler machine for hyd. fittings & dies
- Tap & die set
- Assortment of pipe wrenches
- Assortment of adjustable wrenches
- Bolts & bolt bins
- 2-14.4 volt grease guns
- Assortment of oil, lubes & filters
- Drill press
- Boomers & chains
- 2-overhead chain hoists on A frames
- Wheel pullers
- Circular saws
- Several sockets & ratchets 1/2" to 1"
- Shop vises
- 3 1/2 ton floor jack
- Porta-power 10 ton
- Open & box end wrenches
- Mikita chop saw 14"
- 2-Angle grinders
- 3/8" & 1/2" drills
- Impact wrenches
- Come-a-longs
- Welding helmets
- Porta-cable power washer, 2000 PSI
- All power, power washer, 2000 PSI
- Large shop vac
- New 110 volt fuel pump
- Tractor weights

MISCELLANEOUS

- Hammers, squares & levels
- Screws & nails
- Sledge hammers
- Auto bulbs
- Tool boxes
- Corn knives
- Chisels & punches
- Belts & hoses
- Chain ends
- Trouble lights
- Draw bar for 3pt.
- Clamps, bearings & flanges
- Shop brooms
- Sickle repair
- New 11-L-15 Imp. tires
- Tie down straps
- Fallow-King blades
- Alfalfa seed
- Quikrete
- Roller chain
- BB Radio's
- Trailer for 4-wheeler
- Bolt cutters
- 20-bags of channel feed seed
- New gear box for grain auger
- Paint & supplies
- Schaffers hyd. & engine oil
- Old hand tools
- Paint spray guns
- Car ramps
- Air bubble
- Welding rod
- Electrical cords
- New hyd. hose
- Shovels, brooms & rakes
- Hyd. cylinders
- Avery Jack
- Electric motors
- 5 gal. propane tanks
- Used tires
- Exhaust blower
- Shop fans
- Air & water lines
- Shop & salvage iron
- Net wrap (4-rolls)
- Hitch pins
- Degelman harrows
- 3-hand pumps
- Weed eaters
- Draw out auger for bin
- 2-old pedal tractors (JD)
- Leaf blower
- Alt. & generators
- PU box trailer

TRACTORS

- 2009 J.D. 9330, 4x4, under warranty, 348 hrs., power shift, air ride seat, hardwired for auto steer, 710 Firestone tires, weights inside & out, 4 remotes, 375 hp; Ser. # RW9330P010631
- 2009 J.D. 9330, 4x4, under warranty, 588 hrs., power shift, air ride seat, hard wired for auto steer, 710 Goodyear tires, weights inside & out, 4 remotes, 375 hp; Ser. # RW9330P010617
- 2009 J.D.8130 M.F.W.D. w/J.D. 843 loader w/ grapple fork, 700 hrs., extra wheel weights, duals, power shift, 3pt. wired for auto-steer, air ride seat, reinforced bucket, 4 remotes, extra light kit, 480/80 R 46 Radial rear tires, 480/70 R 30 Radial front tires, 190 hp; Ser. # RW8130P029781
- 1980 J.D. 4840 w/new KW Loader & grapple fork, 20.8x 38 Goodyear radials on rear, quad range, 3 remotes, Ser. # 4840P008593R

LIVESTOCK EQUIPMENT

- 4-8' poly water tanks
- 6 self feeders (3 small, 3 lg.)
- 10 over the top feeders, 16'-24'
- 16 rectangular feed bunks (homemade)
- Hedge post, electric fence post
- Pipe & sucker rod (very little)
- For-Most working chute w/palpation
- Panels & gates
- Mineral feeders
- Bale bed for 16' truck
- 3-overhead grain bins (1-20 ton, 2-14 ton)
- Livestock meds
- Hiplock for livestock
- Cake feeder
- Calf Sheds
- Cattle guards
- CO2 Dart guns (1-rifle, 1-pistol)
- Tattooer
- Fence chargers (solar)
- Gopher getter
- Wire stretchers
- 2-10' Bale forks

FUEL TANKS

- 3000 gal. tank on skid, diesel
- 1000 gal. tank on skid w/electric pump, diesel
- 500 gal. tank on stand, diesel
- 300 gal. gas tank
- 300 gal. gas tank with stand
- 120 gal. slide in diesel tank with electric pump
- 100 gal. gas tank on stand

COMBINE & HEADER

- 2008 J.D. 9670 STS, Bullet Rotor, 2 wheel drive, straw chopper, extended auger, air ride seat, grain moisture tester, bushel calibration, under lighting, grain loss monitor, 604 separator hrs. 877 eng. hrs.
- Hrs. Ser. # H09670S725290, 800/70 R38 Drive tires
- 2009 J.D. 6300, 30' Draper header w/ hydra float, pickup reel, single sickle, under warranty, Ser. # H00630D730257, gauge wheels

SWATHER, BALER, & RAKE

- J.D. 4890 Swather, 18' reel, 18.4-26 tires, Ser. # E04890X130089, hydrostat, double sickle, heavy duty gear boxes, air ride seat, 2759 hrs.
- 2007 J.D. 568 Round baler, twine or net wrap, mega wide plus Ser. # E00568X337695
- H&S High capacity bifold rake, 16 wheel, 32'; Ser. # 017610

4-WHEELER & MOWERS

- Polaris Sportsman x 2 = 700, 4x4, automatic, front & back guard, 2728 miles, 616 hrs., electric fuel injection.
- J.D. F-911 60" deck hydrostat
- Land Pride 5' rotary mower

HOUSEHOLD

- Oak dining room table w/ Queen Ann legs & 6 chairs
- Oak buffet (2 drawers, 2 doors)
- Oak tea cart
- Oak entertainment center
- Oak roll top desk
- Oak wash stand
- 5 piece Oak bedroom set
- French Provincial side-board w/marble top
- Kenmore refrigerator
- Kenmore microwave
- Sansui 16" flat screen
- 300 gal. gas tank
- Coffee table w/folding leaves
- End tables & lamps
- Clocks & wall hangings
- Electric lift chair
- Gun cabinet
- Maytag washer, dryer & dishwasher
- 4-kitchen chairs
- DVD & CD player
- Patio table w/8 chairs
- Water fountain
- Double seat patio chair
- Lawn ornaments
- Coffee maker
- Canister set
- Pillows & blankets
- Towels & linens
- Dishes, pots, pans
- Porch swing
- Large umbrellas
- X-mas decorations
- Shelving
- Mirrors
- Gun cases
- Fireplace doors
- Storage cabinet



TERMS & CONDITIONS:

- ◆ CASH DAY OF SALE. ONLY CHECKS WITH PROPER I.D. ACCEPTED.
- ◆ ANNOUNCEMENTS MADE DAY OF SALE TAKE PRECEDENCE OVER PRINTED MATERIAL.

Lunch will be served.

SELLER: Everett McKenna Estate

Attorney for the Estate is Leslie A. Hess, 1200 Main Street , Hays, KS 67601
Executor for the Estate is Dustin Bemis: (785) 650-9310
Ranch Forman is Rick Lewis: (785) 662-8020

Farmland Auction & Realty Co., Inc.

2707 Broadway, Hays, Kansas 67601

(785) 628-2851 Toll Free 1-888-671-2851

E-Mail: farmland@farmlandauction.com Web: www.farmlandauction.com

